

1. Product Overview

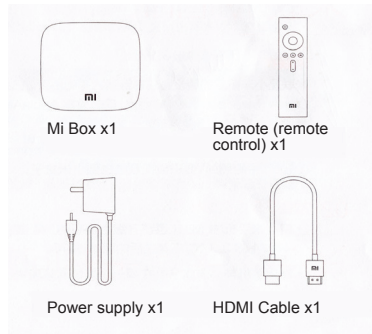

2. Connection Ports

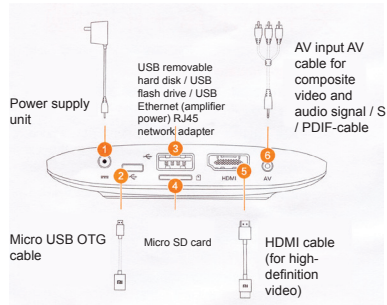

Additional components (accessories) can be ordered and purchased separately, after a visit and register on the official website Xiaomi www.xiaomi-mi.com

3. Overview of Mi Box components

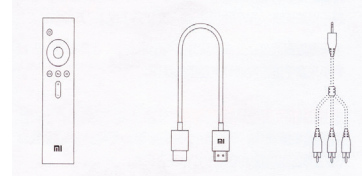

Remote (Remote Control)

Very easy to use, can be used to control Mi Box and Mi TV

Standard HDMI Cable

Supports 192kHz frequency sound

AV cable (composite video and audio)

Make old TV «smart»! Screen connection to a power amplifier, supporting of SD-signal format.

4. Overview of Mi Box components

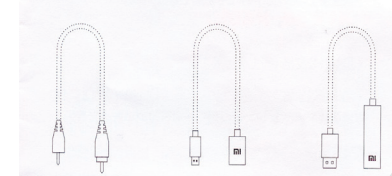

S / PDIF-cable

Connecting the power amplifier, supporting frequency of 24bit / 192kHz, continuous transmission of audio files

OTG cable

Allows Mi phone, Mi Box easily read audio and video files from a USB flash drive or hard disk.

USB Ethernet RJ45 (power amplifier)

Enjoy high-speed wired Internet stable, supported by Mi Box, PC, MAC

5. Standard Installation

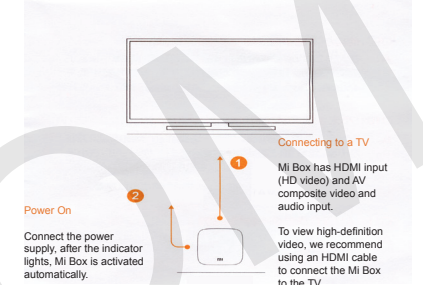

6. Using the remote control

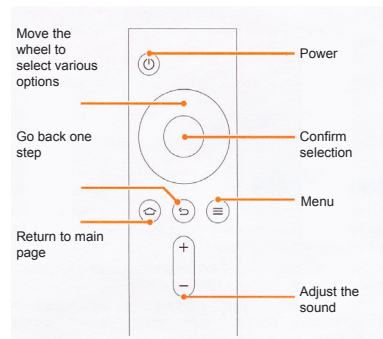

7. Using the remote control

Home: a rapid return to the main page

Menu: demonstration of the interface and various functions

For example: on the main interface page, enter in the search that you want to view, and displays a selection of these videos; there are large selection of other videos on the home screen.

Move selection and different options: focus control (up, down, left, right).

While viewing, press Right, Left allow forward or rewind the file back.

Confirm selection: while watching the video lets stop him pause.

Return: Return one step back

NEW!

There is a mobile version of the Mi remote control!

Leave the last trouble with the remote control, you can now remotely controls Mi Box via a mobile app!

Open the Mi Store, locate and install on your mobile phone «Remote Control» application.

And you'll be pleasantly surprised!



Mi Box

www.Xiaomi-Mi.com